

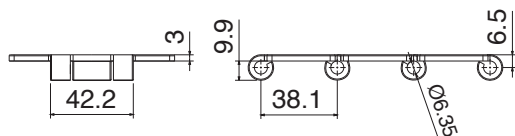

## 881 M catena curvilinea / Sideflexing chain / kurvengängige Scharnierbandkette

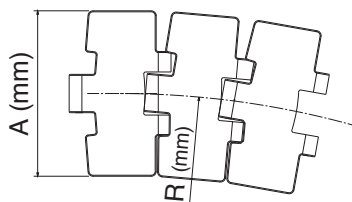

**▣▣▣ Magnetic System**



Part	Article-Nr.	Ref.	A	R	Weight kg/m	Max working load
1008	10080202	SS 881 MO K325	82,5	500	2,55	4000 N
1008	10080203	SS 881 MO K330	83,8	500	2,59	
1008	10080205	SS 881 MO K450	114,3	500	3,10	
1008	10080207	SS 881MO K750	190,5	500	4,85	

1008	10080102	SSE 881 MO K325	82,5	500	2,55	6000 N
1008	10080103	SSE 881 MO K330	83,8	500	2,59	
1008	10080105	SSE 881 MO K450	114,3	500	3,10	
1008	10080107	SSE 881 MO K750	190,5	500	4,85	

1008	10080302	SSM 881 MO K325	82,5	500	2,55	6000 N
1008	10080303	SSM 881 MO K330	83,8	500	2,59	

### Material

- 01 **SSE** Super-hard stainless steel
- 02 **SS** Standard stainless steel
- 03 **MX** **▣▣▣ Max speed**

Pins: Ferritic Stainless Steel



## 881 TAB catena curvilinea / Sideflexing chain / kurvengängige Scharnierbandkette

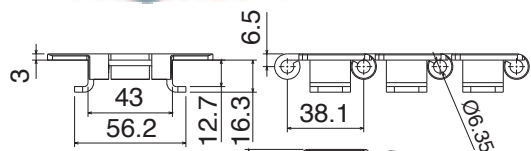

**▣▣▣ Tab System**

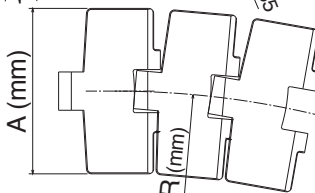

Part	Article-Nr.	Ref.	A	R	Weight kg/m	Max working load
1010	10100202	SS 881 TAB K325	82,5	457	3,00	4000 N
1010	10100102	SSE 881 TAB K325	82,5	457	3,00	6000 N
1010	10100105	SSE 881 TAB K450	114,3	500	3,69	
1010	10100107	SSE 881 TAB K750	190,5	500	5,50	

### Material

- 01 **SSE** Super-hard stainless steel
- 02 **SS** Standard stainless steel

Pins: Austenitic Steel

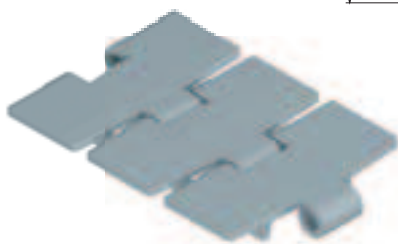

## 881 B catena curvilinea / Sideflexing chain / kurvengängige Scharnierbandkette

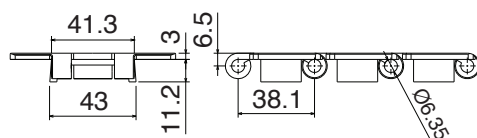

**▣▣▣ Bevel System**

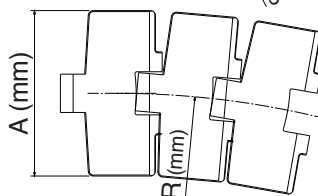

Part	Article-Nr.	Ref.	A	R	Weight kg/m	Max working load
1012	10120102	SSE 881 K325	82,5	457	2,95	6000 N
1012	10120105	SSE 881 K450	114,3	500	3,65	
1012	10120107	SSE 881 K750	190,5	500	5,45	

### Material

- 01 **SSE** Super-hard stainless steel

Pins: Austenitic Steel

